

the phoenix™



The 44" Phoenix™ is a professional grade mounting laminator. Robustly designed, **the Phoenix™** uses a metal frame construction with high quality 4" diameter silicone rollers for professional results. Two speeds and temperature settings allow **the Phoenix™** to work with all medias and laminates.

Now, for the first time, you have the capability to use **roll film** with the factory installed **roll film kit**. This added feature allows you to easily achieve the look you want while saving time and money!

FEATURES:

- Clear protective safety shield
- Single control roller height adjustment
- Print feed guides
- Large 4" diameter silicone rollers
- Roll lamination kit
- Rugged design
- Two temperature settings
- Two speed settings
- Minimal set-up time
- Mounts & laminates most types of materials up to 1/4" thick
- Optional integrated cart or stand
- Optional cutter

Control Panel

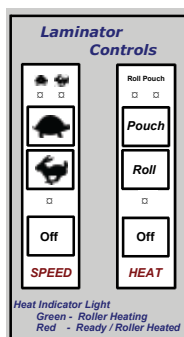

Two - Speeds

Heat settings for pouches and roll film

Turn heat off for cold film

Free Start-Up Package Includes:

- 1 - 38" x 50' Gloss 5 Mil Digital Roll Film
- 5 - 25" x 37" Mounting Boards *
- 5 - 25" x 37" Gloss Pouch Boards *

* Mounting & Gloss Pouch Boards Are 1 Box

Roll Film Kit

Consists of a roll film dispensing bar for films on 3" cores. Includes brake tension and idler bar for film positioning. Front panel doubles as a safety shield.

OPTION:

Phoenix Stand

Heavy-duty welded steel frame with 2 storage shelves and 4 locking caster wheels. This stand is designed for use with the Phoenix laminator so that you can conveniently store the supplies and film with your Phoenix laminator, and, move it all out of the way when not in use.

Stand size: 47"L x 30-3/4"H x 19-3/4"D



SPECIFICATIONS:

Maximum print width	43"
Maximum board thickness	1/4"
Maximum speed	1' per minute
Power	110V/18 amps
Dimensions	58" x 12" x 15"
Net Weight	175 lbs
Shipping weight	Approx. 225 lbs Must ship truck